

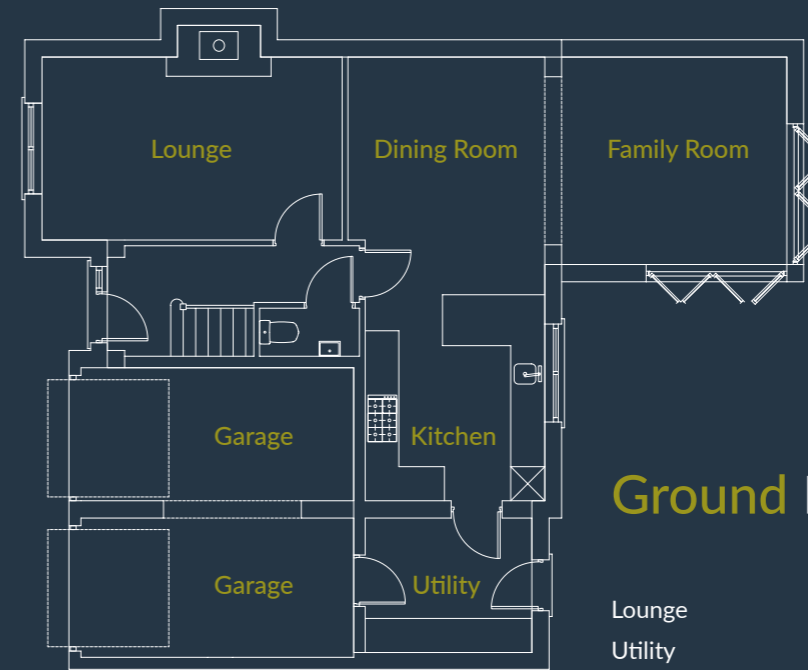

# Four bedrooms

## The Heathwood : Plot 3 & 4

The Heathwood provides an entrance porch into the hallway with cloakroom, leading through to the living room with inglenook fireplace. The property has an open plan kitchen, dining room and family room and separate utility room. The family room has a unique design of corner bifold doors letting the outside into your home. On the first floor there is a master bedroom with ensuite, and 3 further bedrooms and a family bathroom. Plot 3 and 4 have the benefit of an integral double garage.



### Ground Floor

	W x L
Lounge	3.23m x 5.29m (10' 7" x 17' 4")
Utility	2.37m x 2.94m (7' 9" x 9' 8")
Kitchen / Dining	7.82m x 7.74m (25' 66" x 25' 39")
Family Room	4.2m x 3.8m (13' 9" x 12' 5")
WC	0.85m x 1.76m (2' 9" x 5' 9")
Double Garage	5.11m x 4.81m (16' 9" x 15' 9")

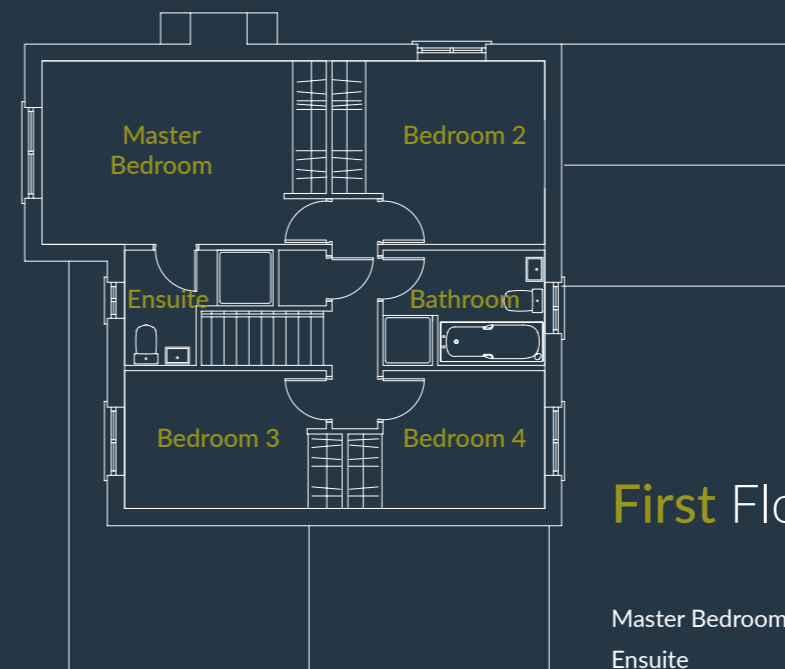

### First Floor

	W x H
Master Bedroom	3.23m x 5.01m (10' 7" x 16' 5")
Ensuite	2.03m x 2.62m (6' 8" x 8' 7")
Bedroom 2	3.23m x 3.16m (10' 7" x 10' 4")
Bedroom 3	2.43m x 3.56m (7' 11" x 11' 8")
Bedroom 4	2.43m x 2.87m (7' 11" x 9' 5")
Bathroom	2.03m x 2.85m (6' 8" x 9' 4")