



Three bedrooms

The Ash : Plots 4, 5, 6, 7, 8 & 9

The Ash is a semi-detached 3 bedroom house, which offers a modern open-plan kitchen/dining room and separate living room. The property benefits from a utility room and downstairs cloakroom. The first floor comprises of the master bedroom with ensuite, and two further bedrooms and a family bathroom.

Ground Floor

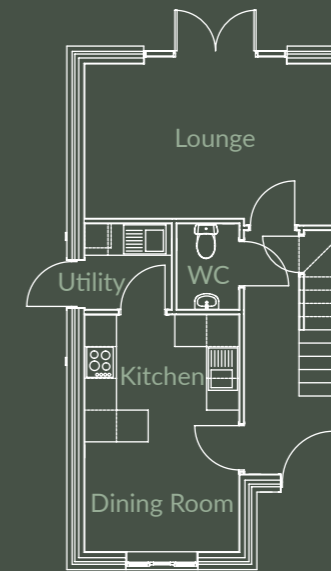

First Floor

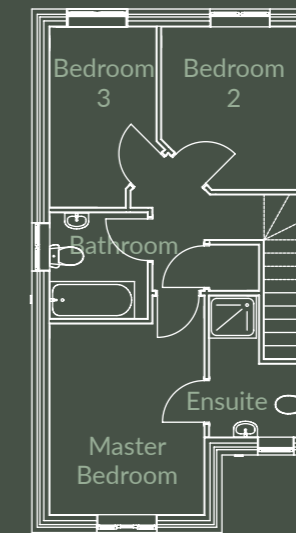

GROUND FLOOR (W x L)

Lounge	4.91m x 3.05m (16'1" x 10'00")
Utility	1.64m x 1.62m (5'5" x 5'4")
Kitchen / Dining Room	2.93m x 4.49m (9'7" x 14'9")
WC	1.18m x 1.62m (3'11" x 5'4")

FIRST FLOOR (W x L)

Master Bedroom	2.92m x 4.14m (9'7" x 13'7")
Ensuite	1.90m x 2.67m (6'3" x 8'9")
Bedroom 2	2.79m x 3.07m (9'2" x 10'1")
Bedroom 3	3.42m x 2.01m (11'3" x 6'7")
Bathroom	1.85m x 2.00m (6'1" x 6'7")