



Four bedrooms

The Victoria : Plot 4

A four bedroom detached property, this is a unique design for The Beeches, situated within a large plot with rural views. This property benefits from spacious open plan living with French doors opening up into the garden. The master bedroom has an ensuite bathroom. The property also has an integral double garage.

Key Details

Ground Floor

- Lounge
- Dining / Family / Kitchen
- Utility
- WC
- Garage

First Floor

- Master Bedroom
- Ensuite
- Bedroom 2
- Bedroom 3
- Bedroom 4
- Bathroom

Explore The Victoria...

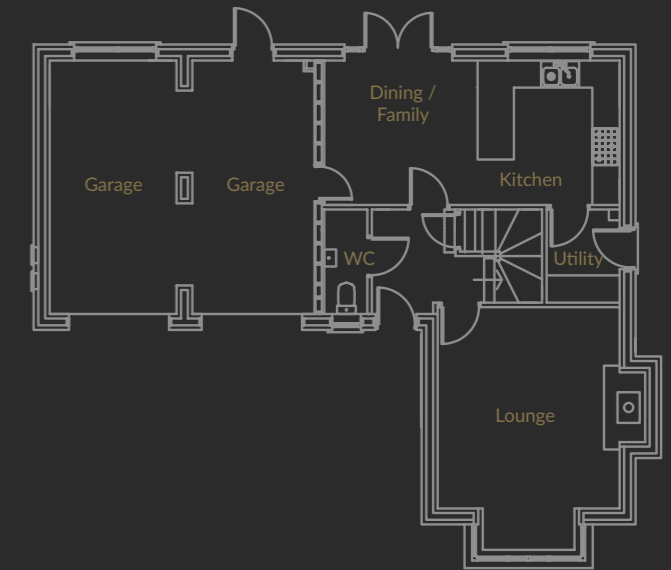

W x H

Lounge	4.41m x 4.01m (14' 4" x 13' 1")
Dining / Family / Kitchen	6.51m x 3.18m (21' 4" x 10' 5")
Utility	2.05m x 1.61m (6' 8" x 5' 3")
WC	2.30m x 0.95m (7' 6" x 3' 1")
Garage	3.84m x 5.59m (12' 6" x 18' 3")

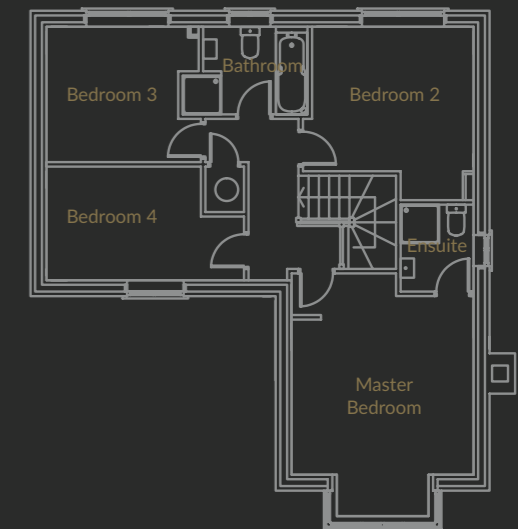

W x H

Master Bedroom	4.41m x 4.01m (14' 5" x 13' 2")
Ensuite	1.61m x 1.92m (5' 3" x 6' 3")
Bedroom 2	3.82m x 3.76m (12' 6" x 12' 4")
Bedroom 3	3.40m x 2.98m (11' 1" x 9' 9")
Bedroom 4	4.35m x 2.50m (14' 3" x 8' 2")
Bathroom	2.75m x 1.93m (9' x 6' 3")

